

The Downhill Dan 10 extrusion is our most compact profile. At only 10mm deep, it's ideal for tight spaces and minimal visual impact. "Dot-free" lighting can be achieved when combined with our "Spec Series Slim" range of LED strip.

MOUNTING OPTIONS	DIFFUSER OPTIONS	SUPER SERIES LED STRIP OPTIONS	SPEC SERIES 'SLIM' LED STRIP OPTIONS				
Surface mounted	Opal	Lumens per metre	Watts per metre	Colour temp.	Lumens per metre	Watts per metre	Colour temp.
Recessed	Clear	310lm		2700K	785lm		3000K
		330lm	3W	3000K	810lm	9.6W	4000K
		345lm		4000K	1050lm		3000K
		760lm		2700K	1080lm	14W	4000K
		800lm	7W	3000K			
		840lm		4000K			
		1520lm		2700K			
		1600lm	14W	3000K			
		1680lm		4000K			

- LED strip options vary depending on region – please consult your local distributor for more information. Other LED strip options are available on request, including IP54.  
- All lumen values refer to the bare LED strip. Losses through diffuser/profile are not represented. Consult photometric data.  
- 5 year manufacturer's warranty on Super Series & Spec Series LED strip.

## ACCESSORIES

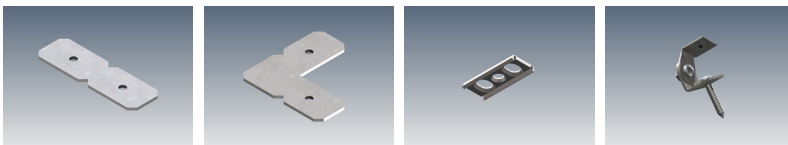

JN-ST Straight joiner      JN-90 90 degree joiner      JMC-12 Joinery mounting clip      MB-ADJ Adjustable mounting bracket

NOTE: Wire or rod suspension accessories are available on request.

## ADDITIONAL INFORMATION

Applications	Task lighting in kitchen cabinetry, shelving or display units, concealed architectural details.
Installation	Interior only.
Materials	Extruded aluminium body, polycarbonate diffuser, AES plastic end caps.
Finish	Natural silver anodised or custom powder coat.
Light source	LED ribbon strip.
Power supply	24V DC - remote driver options ranging from 6W up to 320W.
Dimmable	Various options available, please enquire.

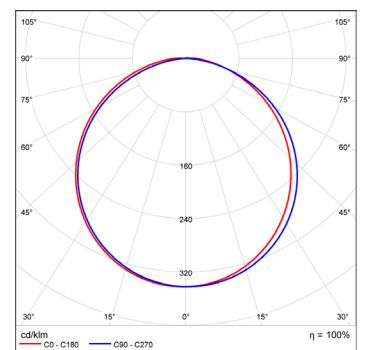

Polar curve for 1340 lumen LED strip with opal diffuser.

