

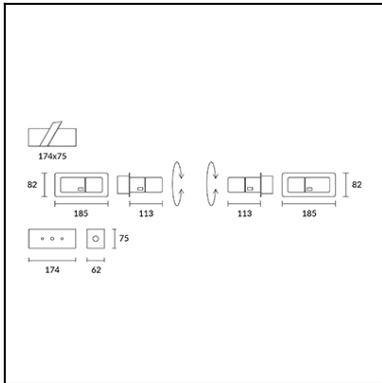

The photograph may not match the reference exactly. Please read the product description to identify the finish.

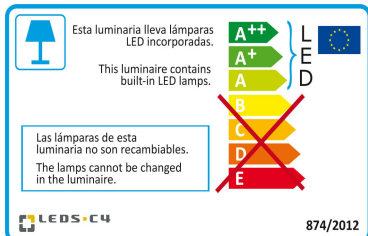

[Download photometric file .ldt /.ies](#)



Click on image to download energy label

TECHNICAL CHARACTERISTICS

Type:	WALL RECESSED
Adjustable:	Adjustable 355° on the horizontal axis. Adjustable ±90° on the vertical axis
IP Protection degrees:	IP20
Light source 1: Bulb specified at the product label	1 x LED Cree 3W Warm White - 3000K 182 lm ^(N) CRI 80
Total power consumption (W):	4.3
Angle of the optics / Reflector:	
Voltage / Frequency:	100-240V/50-60Hz
Warranty:	2
Option to extend the guarantee:	5
Units per box:	6
Net Weight (Kg):	
EAN Code:	8435111098028
CFM:	0.00



MATERIALS / FINISHES

Structure material: Aluminium

Structure finish: Grey

GEAR

Multi-voltage electronic gear included (Yes)

71-1653-34-34

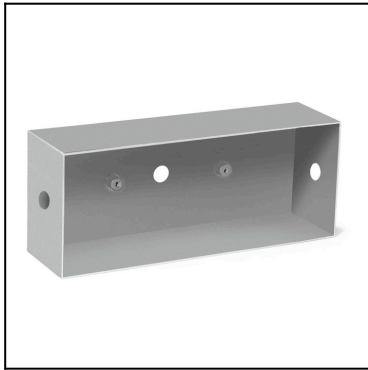
Recessing kit for brick wall

Structure material: Steel
Structure finish: Grey

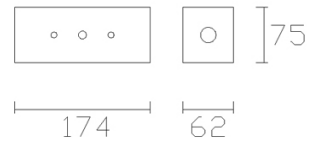

Luminaire		Measur.		Lamp		
Code	05-1531	Code	05-1531	Code	INCANDESCENT	
Name	DESK LAMP	Name	DESK LAMP	Number	1	
Line	Eulumdat	Date	16-11-2013	Position		
Efficiency	64.77%	Coordinate system	CG	Total Flux	710.00 lm	
Maximum value	170.12 cd	Position	C=270.00 G=2.00	Asymmetrical		
Rectangular Luminaire	Length	180 mm	Width	180 mm	Height	1 mm
Rectangular Luminous Area	Length	180 mm	Width	180 mm	Height	0 mm
Horizontal Luminous Area	0.032400 m2	Emitting area on Plane 180°		0.000000 m2		
Emitting area on Plane 0°	0.000000 m2	Emitting area on Plane 270°		0.000000 m2		
Emitting area on Plane 90°	0.000000 m2	Glare area at 76°		0.007838 m2		
Symmetry Type	Asymmetrical	Maximum Gamma Angle		90		
Measurement Distance	0.00	Measurement Flux		710.00 lm		
Operator		Source voltage				
Temperature	25.00 °C	Source current				
Humidity	60.00 %	Photocell				
Notes						

Luminaire Lamps						
Line	Code	Name	Flux [lm]	Pow. [W]	Q.ty	
Eulumdat	INCANDESCENT	INCANDESCENT - 57.40 W	710.00	57.40	1	
C.I.E.	48 83 97 100 65	D DIN 5040		A30		
F UTE	0.65 E	B NBN		BZ 4		

180mm x 180mm

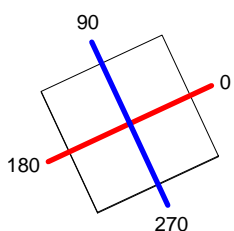

C Halfplanes

180.0 — 0.0

270.0 — 90.0

ULOR 0.00 %

DLOR 64.77 %

RN 0.00 %

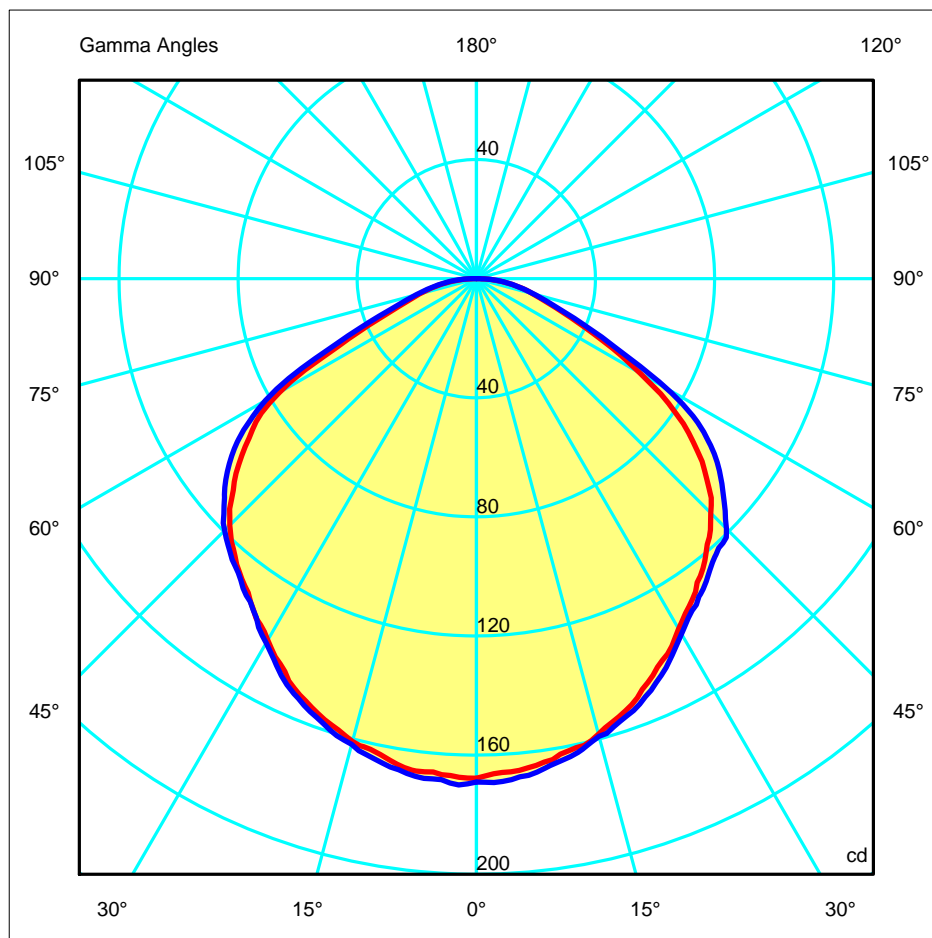

Luminaire		Measur.		Lamp	
Code	05-1531	Code	05-1531	Code	INCANDESCENT
Name	DESK LAMP	Name	DESK LAMP	Number	1
Line	Eulumdat	Date	16-11-2013	Position	
Efficiency	64.77%	Coordinate system	CG	Total Flux	710.00 lm

180mm x 180mm

C Halfplanes

180.0 ——— 0.0
 270.0 ——— 90.0

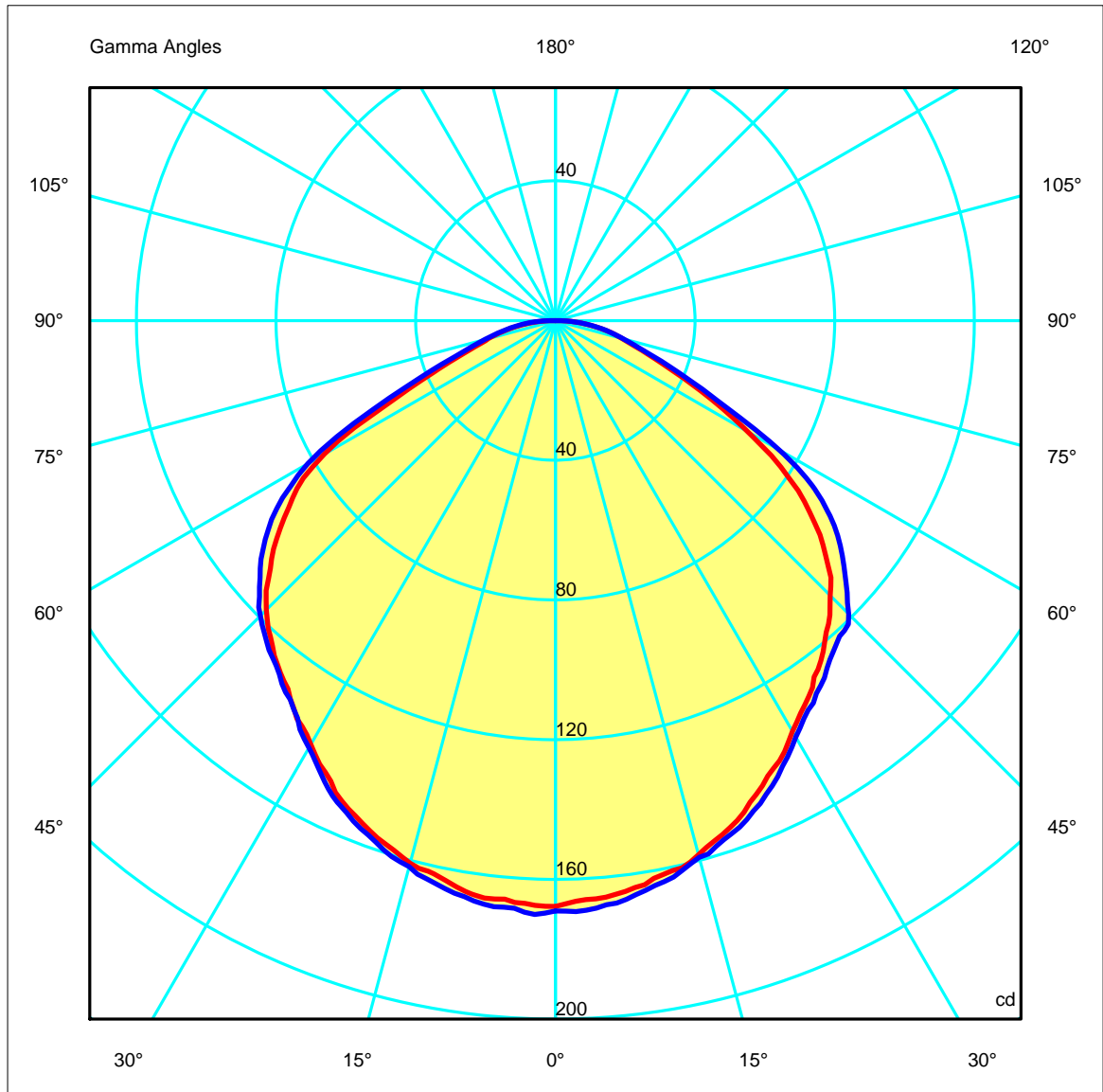
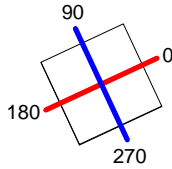

Luminaire	Measur.	Lamp
Code 05-1531	Code 05-1531	Code INCANDESCENT
Name DESK LAMP	Name DESK LAMP	Number 1
Line Eulumdat	Date 16-11-2013	Position

Efficiency	64.77%	Coordinate system	CG	Total Flux	710.00 lm
------------	--------	-------------------	----	------------	-----------

Width at 50.00 % of MaxLux

	H[m]	1.00	2.00	3.00	4.00	5.00		H[m]	1.00	2.00	3.00	4.00	5.00
	OA	1.44	2.88	4.32	5.77	7.21		OC	1.61	3.22	4.82	6.43	8.04
	OB	1.62	3.24	4.86	6.48	8.10		OD	1.70	3.40	5.10	6.80	8.50

Luminous Intensities [cd]

	0	5	15	25	35	45	55	65	75	85
OA	167.71	165.71	158.33	143.90	128.31	111.28	84.89	43.02	19.62	6.83
OB	167.71	166.26	160.83	149.07	132.33	117.10	93.19	46.49	19.84	6.74
OC	169.02	167.90	159.07	146.95	130.32	118.75	95.10	46.43	20.29	6.81
OD	169.02	168.60	161.88	150.55	132.42	119.53	99.22	52.51	20.95	7.77

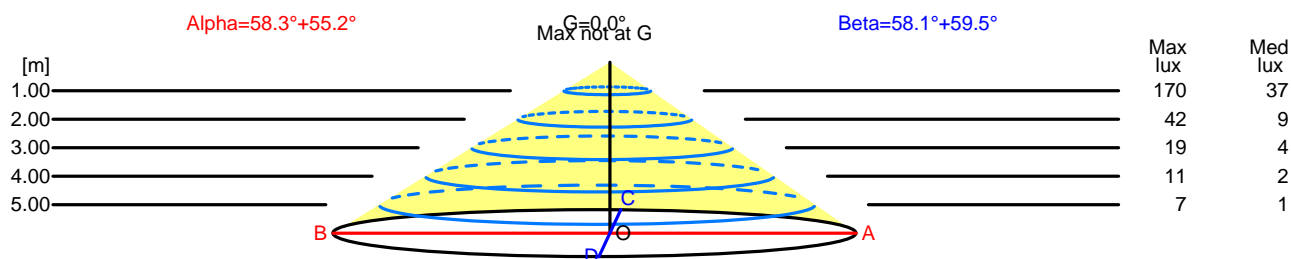

H[m]	D[m]	Max lux	Med lux	Alpha=58.3°+55.2°	G=0.0 Max not at G	
1.00	3.06	170	37			
2.00	6.12	42	9			
3.00	9.18	19	4			
4.00	12.24	11	2			
5.00	15.31	7	1			

H[m]	D[m]	Max lux	Med lux	Beta=59.5°+58.1°	G=0.0 Max not at G	
1.00	3.31	170	37			
2.00	6.61	42	9			
3.00	9.92	19	4			
4.00	13.23	11	2			
5.00	16.53	7	1			

Luminaire		Measuram.		Lamp	
Code	05-1531	Code	05-1531	Code	INCANDESCENT
Name	DESK LAMP	Name	DESK LAMP	Number	1
Line	Eulmdat	Date	16-11-2013	Position	
Efficiency	64.77%	Coordinate system	CG	Total Flux	710.00 lm

Isolux (Floor)

Luminaire position X=0.00m Y=0.00m Z=3.00m

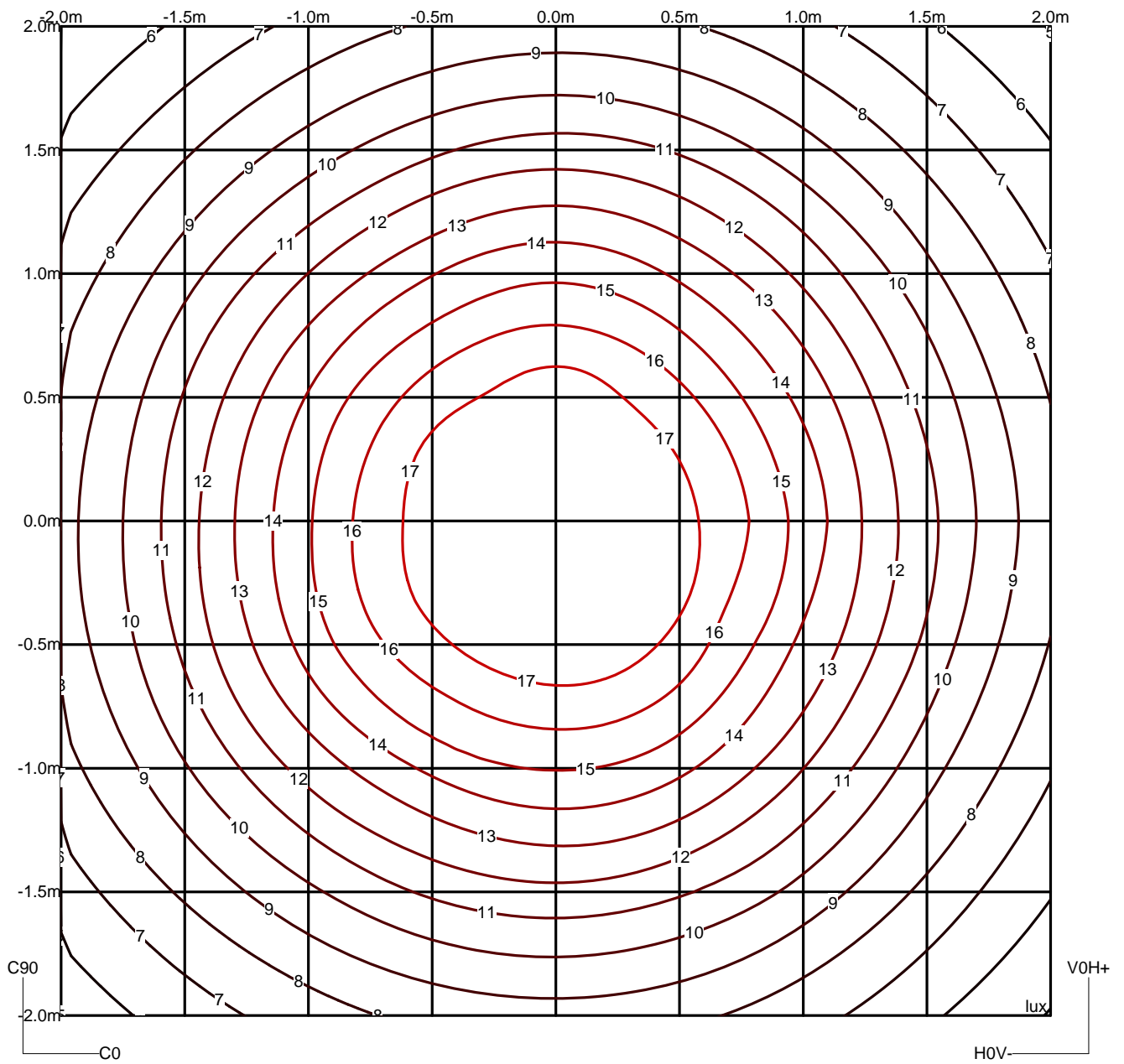

Luminaire

 Code 05-1531
 Name DESK LAMP
 Line Eulumdat

Measur.

 Code 05-1531
 Name DESK LAMP
 Date 16-11-2013

Lamp

 Code INCANDESCENT
 Number 1
 Position

Efficiency 64.77%

Coordinate system CG

Total Flux 710.00 lm

		Average Luminance [cd/m ²]									
		45°	50°	55°	60°	65°	70°	75°	80°	85°	
0.0°		4857	4803	4568	3921	3142	2548	2340	2346	2419	---
90.0°		5183	5171	5117	4565	3391	2671	2420	2412	2412	---

Flush mounted or longitudinal view												
		Illumination(lx)										
A	A	2000	1000	750	500		<300					1.15
B	1		2000	1500	1000	750	500	<300				1.5
C					2000		1000	500	<300			1.85
D	2						2000	1000	500	<300		2.2
E	3							2000	1000	500	<300	2.55

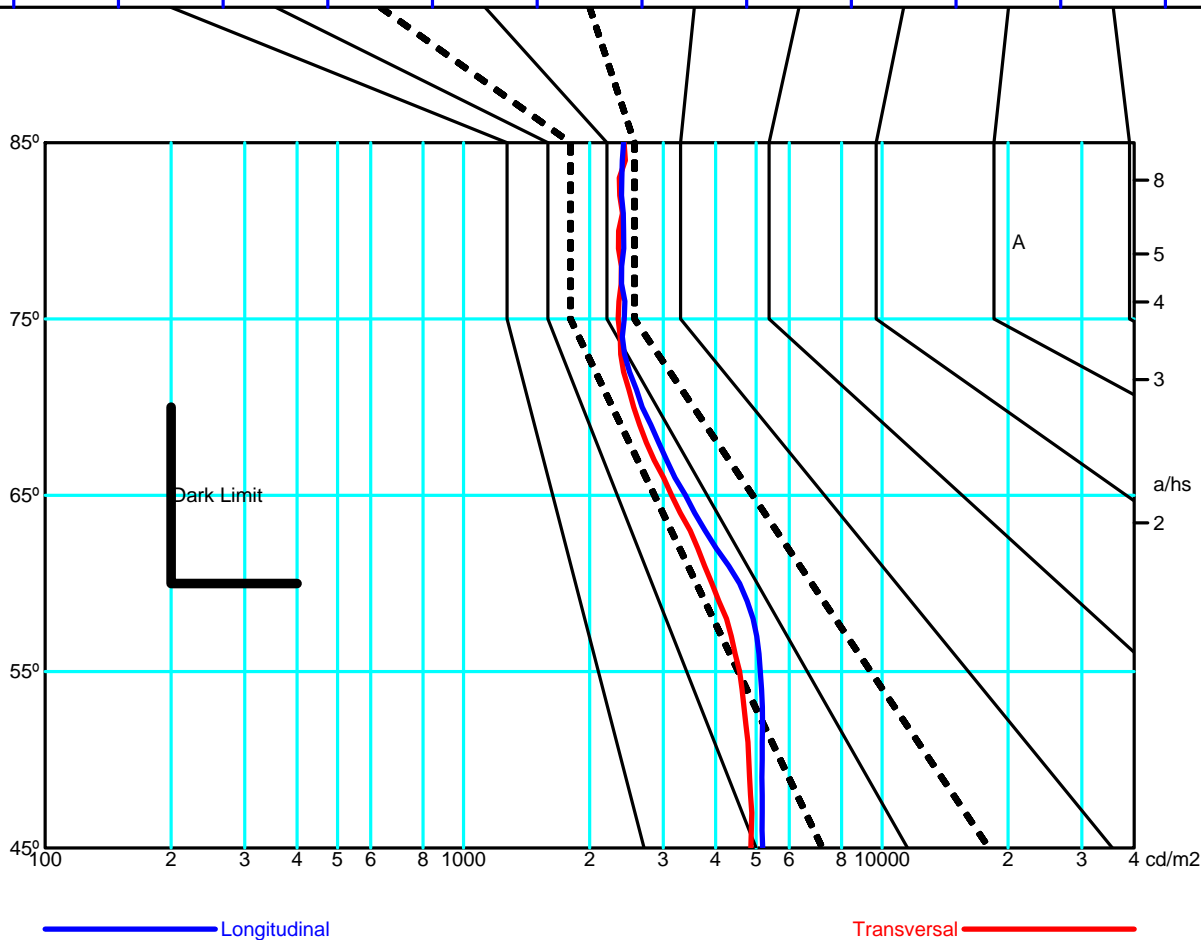

Luminaire		Measur.		Lamp	
Code	05-1531	Code	05-1531	Code	INCANDESCENT
Name	DESK LAMP	Name	DESK LAMP	Number	1
Line	Eulumdat	Date	16-11-2013	Position	
Efficiency	64.77%	Coordinate system	CG	Total Flux	710.00 lm

180mm x 180mm

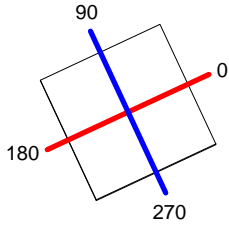

C Halfplanes

180.0 ———— 0.0
 270.0 ———— 90.0

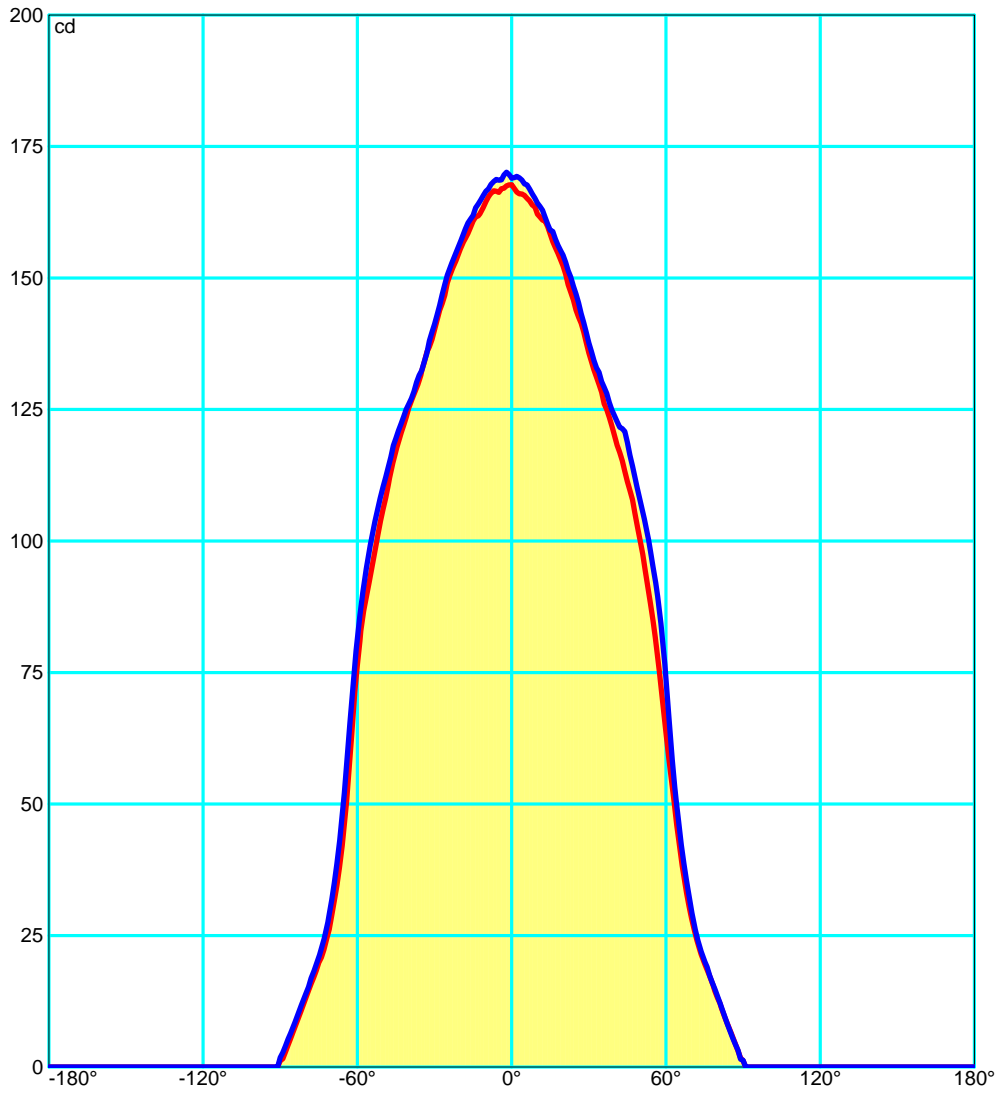

Luminaire		Measur.		Lamp	
Code	05-1531	Code	05-1531	Code	INCANDESCENT
Name	DESK LAMP	Name	DESK LAMP	Number	1
Line	Eulumdat	Date	16-11-2013	Position	
Efficiency	64.77%	Coordinate system	CG	Total Flux	710.00 lm

UGR
S = 0.250

Reflectancies										
Ceiling/Cavity	0.7	0.7	0.5	0.5	0.3	0.7	0.7	0.5	0.5	0.3
Walls	0.5	0.3	0.5	0.3	0.3	0.5	0.3	0.5	0.3	0.3
WorkingPlane	0.2	0.2	0.2	0.2	0.2	0.2	0.2	0.2	0.2	0.2
RoomDimensions	ViewedCrosswise					ViewedEndwise				
x=2H y=2H	18.3	19.7	18.7	19.9	20.3	18.5	19.8	18.8	20.0	20.3
x=2H y=3H	19.1	20.3	19.4	20.6	21.1	19.4	20.5	19.7	20.8	21.1
x=2H y=4H	19.4	20.5	19.7	20.7	21.3	19.6	20.7	20.0	21.0	21.3
x=2H y=6H	19.6	20.6	20.0	20.9	21.5	19.9	20.9	20.3	21.2	21.5
x=2H y=8H	19.7	20.7	20.1	21.0	21.6	20.0	21.0	20.4	21.3	21.6
x=2H y=12H	19.8	20.7	20.2	21.0	21.7	20.1	21.1	20.5	21.4	21.7
x=4H y=2H	18.9	20.0	19.3	20.3	20.7	19.0	20.1	19.4	20.4	20.7
x=4H y=3H	19.8	20.8	20.2	21.1	21.6	20.0	20.9	20.4	21.2	21.6
x=4H y=4H	20.2	21.0	20.6	21.4	21.9	20.4	21.2	20.8	21.6	21.9
x=4H y=6H	20.6	21.3	21.0	21.7	22.3	20.8	21.5	21.2	21.9	22.3
x=4H y=8H	20.7	21.4	21.2	21.8	22.4	20.9	21.6	21.4	22.0	22.4
x=4H y=12H	20.9	21.5	21.3	21.9	22.5	21.1	21.7	21.6	22.1	22.5
x=8H y=4H	20.4	21.0	20.8	21.4	22.0	20.5	21.2	21.0	21.6	22.0
x=8H y=6H	20.9	21.4	21.3	21.9	22.5	21.1	21.6	21.5	22.0	22.5
x=8H y=8H	21.1	21.6	21.6	22.1	22.7	21.3	21.8	21.8	22.3	22.7
x=8H y=12H	21.3	21.8	21.8	22.2	23.0	21.6	22.0	22.1	22.4	23.0
x=12H y=4H	20.4	21.0	20.8	21.4	22.0	20.6	21.1	21.0	21.6	22.0
x=12H y=6H	20.9	21.4	21.4	21.9	22.5	21.1	21.6	21.6	22.0	22.5
x=12H y=8H	21.2	21.6	21.7	22.1	22.8	21.4	21.8	21.9	22.3	22.8

Luminaire

Code 05-1531
 Name DESK LAMP
 Line Eulumdat

Measur.

Code 05-1531
 Name DESK LAMP
 Date 16-11-2013

Lamp

Code INCANDESCENT
 Number 1
 Position

Efficiency 64.77% Coordinate system CG Total Flux 710.00 lm

Pavement			Road		
Piano	0	0.00%	Piano	0	0.00%
Piano	-5	3.07%	Piano	5	3.06%
Piano	-10	6.13%	Piano	10	6.09%
Piano	-15	9.13%	Piano	15	9.04%
Piano	-20	12.05%	Piano	20	11.91%
Piano	-25	14.87%	Piano	25	14.66%
Piano	-30	17.57%	Piano	30	17.29%
Piano	-35	20.12%	Piano	35	19.78%
Piano	-40	22.52%	Piano	40	22.12%
Piano	-45	24.76%	Piano	45	24.30%
Piano	-50	26.79%	Piano	50	26.26%
Piano	-55	28.58%	Piano	55	27.95%
Piano	-60	30.04%	Piano	60	29.28%
Piano	-65	31.09%	Piano	65	30.21%
Piano	-70	31.78%	Piano	70	30.85%
Piano	-75	32.26%	Piano	75	31.30%
Piano	-80	32.59%	Piano	80	31.62%
Piano	-85	32.80%	Piano	85	31.81%
Piano	-90	32.89%	Piano	90	31.88%

Tilting Angle = 0.0

DLOR = 64.77%

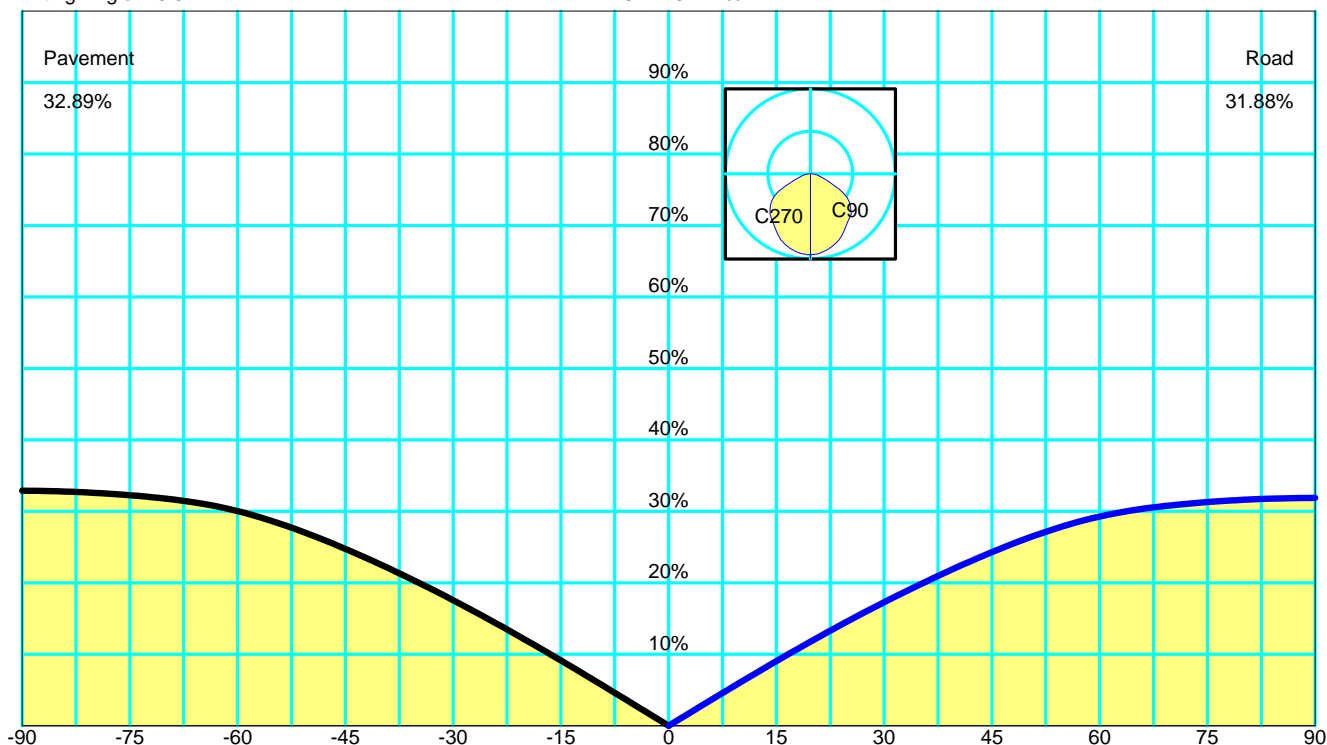

Spread	20.8° Narrow	DLOR	64.77454 %
Throw	11.5° Short	ULOR	0.00000 %
SLI (glare)	8.4 Tight	Efficiency	64.77454 %
CIE Cutoff	Cutoff - Max: C=270.0° Gamma=2.0°	RN	0.00000 %
IESNA Cutoff	Cutoff	Luminous Intensity Class	G5
DIN5044	KB1	Glare Index	D6

IESNA Type V Very Short Quadrilateral Symmetry

Luminaire	Measur.	Lamp
Code 05-1531	Code 05-1531	Code INCANDESCENT
Name DESK LAMP	Name DESK LAMP	Number 1
Line Eulumdat	Date 16-11-2013	Position

Efficiency 64.77% Coordinate system CG Total Flux 710.00 lm

Total Flux=710.00 Luminaire Flux=459.90

RI	0.60	0.80	1.00	1.25	1.50	2.00	2.50	3.00	4.00	5.00	10.00	20.00
DRR	0.31	0.40	0.48	0.56	0.61	0.70	0.75	0.79	0.84	0.87	0.93	0.96
RC	5	5	5	5	4	4	4	4	4	4	5	5

Zonal Flux per 1000 Lumen

Y°	10	20	30	40	50	60	70	80	90	100	110	120	130	140	150	160	170	180
ZF(Y)	22	86	181	297	423	539	607	637	648	648	648	648	648	648	648	648	648	648

CIE Flux Codes

48 83 97 100 65

C.I.E.	5/5/5/5/4/4/4/4/4/5/5	LOR	64.77454 %
D DIN 5040	A30	ULOR	0.00000 %
F UTE	0.65 E	DLOR	64.77454 %
B NBN	BZ 4	UFF	0.00000 %
RN	0.00000 %	DFF	100.00000 %
BLF	1.0	FFR	0.00000 %

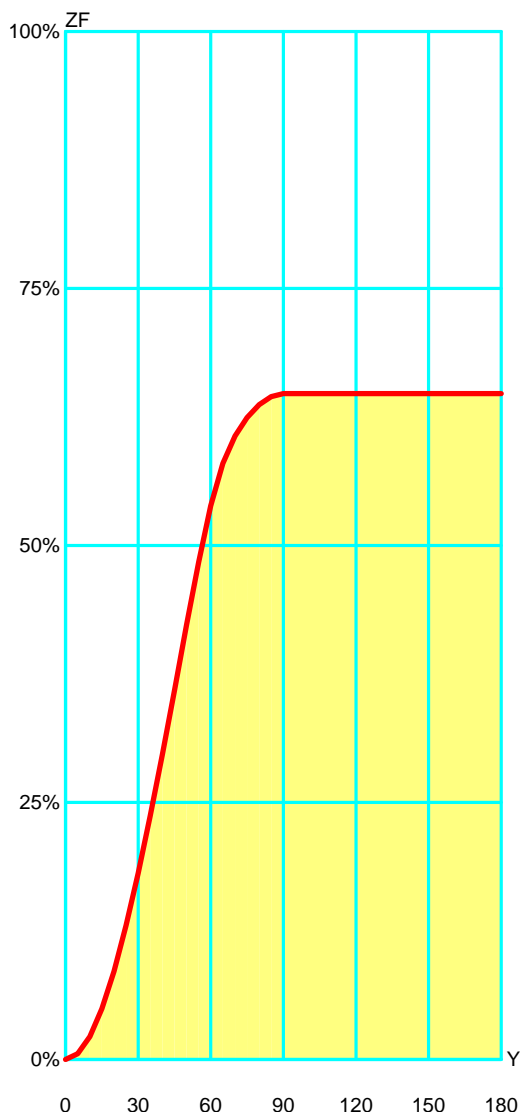

Zonal Flux				
Gamma °	Flux	Sum lm	Flux [%]	Sum [%]
0°	0.00	0.00	0.00%	0.00%
5°	5.64	5.64	0.87%	0.87%
10°	16.70	22.34	2.58%	3.45%
15°	27.06	49.40	4.18%	7.63%
20°	36.42	85.81	5.62%	13.25%
25°	44.49	130.30	6.87%	20.12%
30°	50.89	181.20	7.86%	27.97%
35°	55.73	236.92	8.60%	36.58%
40°	59.69	296.61	9.22%	45.79%
45°	62.64	359.26	9.67%	55.46%
50°	63.52	422.78	9.81%	65.27%
55°	61.12	483.89	9.44%	74.70%
60°	54.69	538.58	8.44%	83.15%
65°	41.26	579.84	6.37%	89.52%
70°	26.71	606.55	4.12%	93.64%
75°	17.80	624.36	2.75%	96.39%
80°	12.62	636.98	1.95%	98.34%
85°	7.79	644.77	1.20%	99.54%
90°	2.97	647.75	0.46%	100.00%
95°	0.00	647.75	0.00%	100.00%
100°	0.00	647.75	0.00%	100.00%
105°	0.00	647.75	0.00%	100.00%
110°	0.00	647.75	0.00%	100.00%
115°	0.00	647.75	0.00%	100.00%
120°	0.00	647.75	0.00%	100.00%
125°	0.00	647.75	0.00%	100.00%
130°	0.00	647.75	0.00%	100.00%
135°	0.00	647.75	0.00%	100.00%
140°	0.00	647.75	0.00%	100.00%
145°	0.00	647.75	0.00%	100.00%
150°	0.00	647.75	0.00%	100.00%
155°	0.00	647.75	0.00%	100.00%
160°	0.00	647.75	0.00%	100.00%
165°	0.00	647.75	0.00%	100.00%
170°	0.00	647.75	0.00%	100.00%
175°	0.00	647.75	0.00%	100.00%
180°	0.00	647.75	0.00%	100.00%

Luminaire Code 05-1531 Name DESK LAMP Line Eulumdat	Measur. Code 05-1531 Name DESK LAMP Date 16-11-2013	Lamp Code INCANDESCENT Number 1 Position
---	---	--

Efficiency	64.77%	Coordinate system	CG	Total Flux	710.00 lm
------------	--------	-------------------	----	------------	-----------

US ROAD STANDARDS

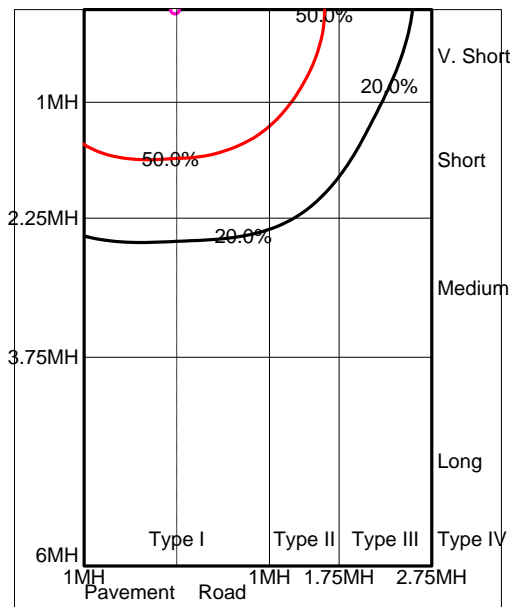
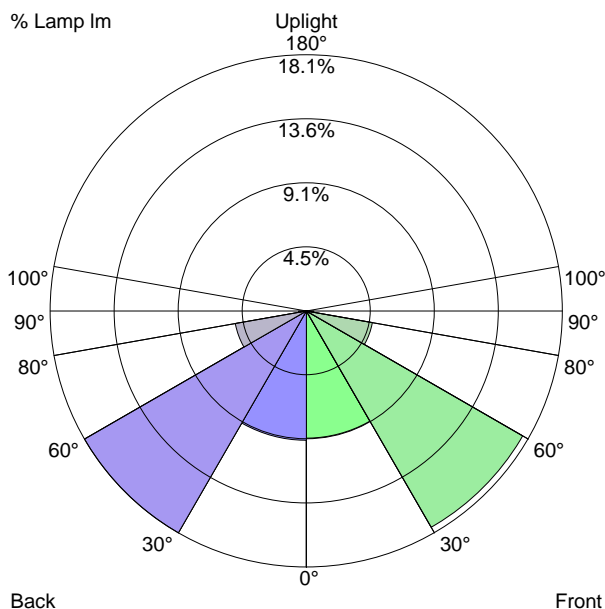

Luminaire Classification System (LCS)			
LCS Zone		Lumens	%Lamp %Lum
FL	0° -- 30°	63.8 lm	9.0 % 13.9 %
FM	30° -- 60°	125.3 lm	17.7 % 27.2 %
FH	60° -- 80°	33.6 lm	4.7 % 7.3 %
FVH	80° -- 90°	3.7 lm	0.5 % 0.8 %
BL	0° -- 30°	64.9 lm	9.1 % 14.1 %
BM	30° -- 60°	128.5 lm	18.1 % 27.9 %
BH	60° -- 80°	36.2 lm	5.1 % 7.9 %
BVH	80° -- 90°	4.0 lm	0.6 % 0.9 %
UL	90° -- 100°	0.0 lm	0.0 % 0.0 %
UH	100° -- 180°	0.0 lm	0.0 % 0.0 %
TOTALS		459.9 lm	64.8 % 100.0 %
BUG B0 U0 G0 Type V Very Short Quadrilateral Symmetry			

1

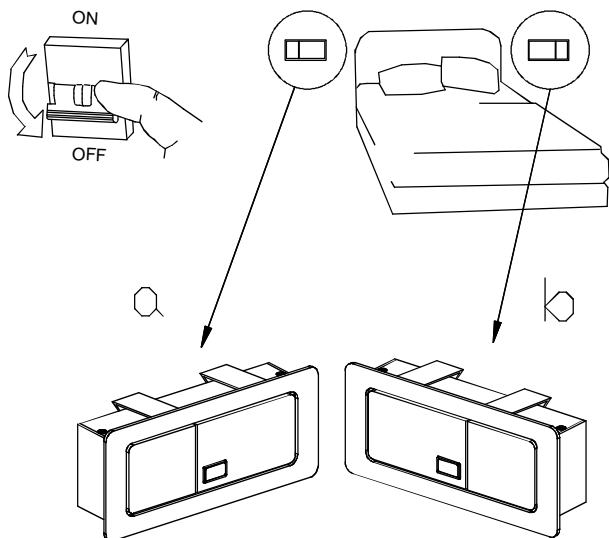

2

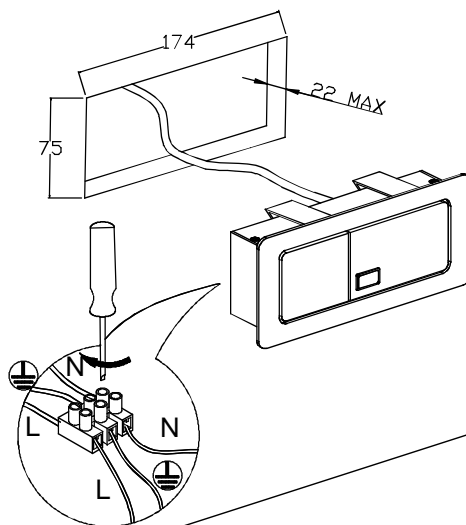

3

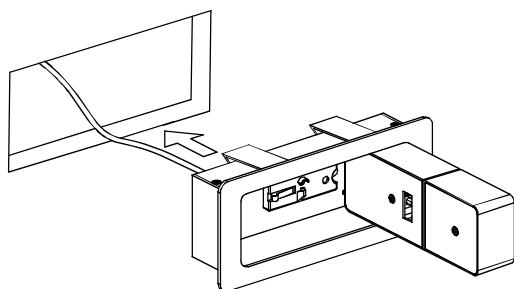

4

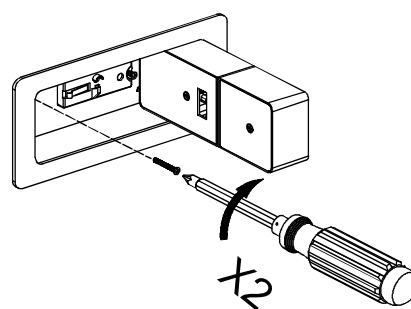

5

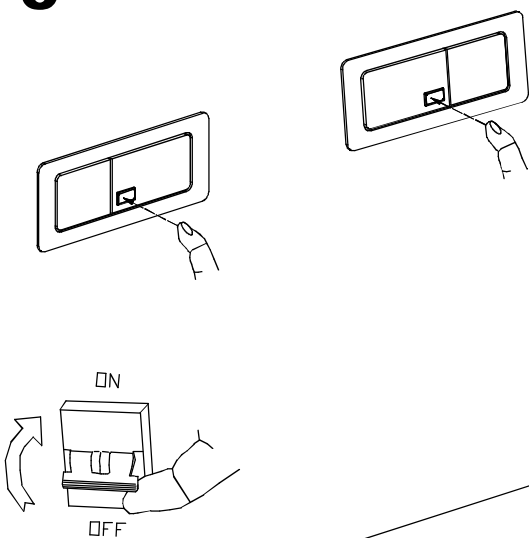

6

